

**YANGEBUP
PRIMARY
SCHOOL
2021
Handbook**





Address:
Email:
Telephone:

55 Moorhen Drive, Yangebup, W.A. 6164
Yangebup.ps@education.wa.edu.au
08 9395 3200



Yangebup Primary School has a very strong sense of community, where relationships between staff, parents and community are based, mutually, on respect, trust, confidence, empathy and co-operation. The school is strengthened by its strong collegial atmosphere where all staff are experienced and competent practitioners who provide education support and pastoral care for students. Our mantra, 'Every Child Matters' is reflected in all aspects of the school day.



Yangebup Primary School opened in 1982 and is located in the southern suburbs, catering for students from Kindergarten to Year 6. The school population consists of students from wide cultural backgrounds, providing rich and diverse opportunities for all. Our school grounds complement the surrounding natural landscape and include vast playing fields and facilities enhanced by native flora.



The school is dedicated to providing a positive educational experience supporting the academic, social, emotional and behavioural needs of the students.



Early intervention, specialised literacy and numeracy programs in the early childhood area provide the students with a solid foundation and start needed for learning.

Yangebup Primary School provides a safe and supportive environment dedicated to giving children endless opportunities to learn, create and become responsible citizens and lifelong learners.

The Habits of Mind program is a whole school approach to learning, teaching students necessary skills to become creative, skilful problem solvers and effective, successful learners.





Dedicated literacy and numeracy specialists and programs provide rigorous curriculum challenges to extend our students.

A supportive and differentiated curriculum encourages students with learning difficulties to achieve their potential and beyond.

Science is a hands-on, investigative program run by a specialist teacher.

Specialised programs and opportunities are provided throughout the year. Programs run in the past have included Dance Club, Chess Club, digital photography, music, engineering and robotics



An extensive visual arts program is widely recognised in the community with many students receiving Art scholarships in specialised secondary schools.

The Japanese language is taught from years 1-6.

At our school we offer a specialist instrumental program for the guitar, and piano.



Through an organised lunchtime sports program of modified team games, teamwork, sportsmanship, participation and physical activity are encouraged for students in Years 3-6.



Yangebup Primary School is well resourced in technologies, providing instant access to information. Laptops, iPads, interactive whiteboards and digital media are available to students to support curriculum delivery, whilst our resource centre is managed by a very passionate and dedicated library officer who ensures the centre is well utilised.

The student parliament is a group of elected Year 6 students who are recognised and selected for their leadership skills. The parliament simulates the State Parliament, with ministries and shadow ministries formed to carry out many responsibilities around the school, including running our whole school assemblies.

School Assemblies are held fortnightly* on a Wednesday, starting at 2.15pm, in our Undercover Area. (**this has been disturbed during 2020 due to COVID*).

Our School Chaplain Joel supports the school's Pastoral Care and Values programs including a School Mentoring Program.



Fundraising:



During the year we hold 'fun' days to help raise money for worthwhile causes and the school. In the past these have included 'Wear Red' (for Daniel Morcombe day), Crazy Hair, Twins, Hero days, Bootclub, Dance Concert and the Colour Explosion Run to name just a few. In 2020, we held a Walkathon around the lake fundraiser which has proved very successful, and extremely popular.

P & C and School Council

Our active P & C committee and School Council work to support our initiatives such as being a Water Wise and Sun Smart school, the vegetable/orchard gardens, Aboriginal Seasons garden and worm farm, dance program, our school uniform shop, school banking, school sport program, Crunch 'n Sip initiative and Chess Club activities. Our P&C meet on the first Wednesday of each month in the Staffroom, commencing at 6.30pm.



School Councils are the governance body of each school. Yangebup has an active and involved school council that guides the direction of our school.

Out of School Care

Teddy Bear Corner OSHC Club– outside school hours care, provides support for working parents with before and after school care within our grounds. A Vacation program is also available. For details of services provided please contact us on 9337 3538.

Our programs are designed to develop stronger, healthier and happier children and to provide an environment that is like a “home away from home”.

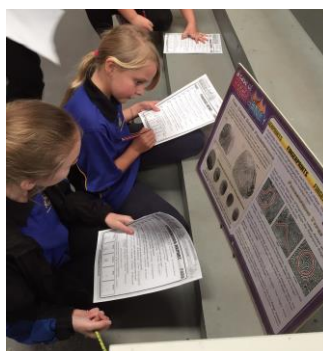

Absence

Parents are asked to contact the school via telephone, email or Skoolbag app if their child is unable to attend. We request that parents advise the school in writing if planning any holidays within the school term.

Late Arrivals

If your child arrives at school after the start siren at 8.40am, then they will need to collect a late slip from the office.

Student Release

Parents/guardians who wish to take their child/children out of class during the school day MUST report to the office to complete a Student Leave Pass. Once this has been authorized by a staff member it then needs to be handed to the classroom teacher.

Car Parking

Off road parking is available either by the tennis courts or Kindergarten on Osprey Drive, at the bottom of Moorhen Drive, or behind the shops on Swallow Drive.

At no stage are Parents to use the Staff Carpark as this can cause a dangerous situation due to staff vehicles, delivery trucks and school buses using this carpark.

Bell Times

Start of Day:	8.40am
Recess:	11.00am
Lunch – Seated and eating:	12.50pm
Playing time:	1.00pm
End of Lunch session:	1.30pm
Final Siren for Day	2.55pm

Students may not come to school before **8.30am**. School starts at 8.40am. We cannot offer supervision any earlier than 8.15 and it is an Education Department requirement that students are supervised when on campus.

Canteen

Canteen facilities are available on Monday and Thursdays for lunch orders only. Orders must be received by 8.50am. Any late orders should be taken to the office ladies who will then ring the order through.

School Uniform

The way the uniform is worn makes a statement about our school. At all times students are to wear the uniform with pride and respect for all that it symbolises.

Wearing of the school uniform is compulsory at this school. Hair must be neat and tidy, and all long hair **MUST** be tied back. Long loose hair encourages the spread of head lice so hair needs to be tied back at all times whilst at school. Jewellery is limited to watches and earrings, if permitted by parents, but these should be either studs or sleepers. We discourage necklaces, bracelets, rings or long earrings being worn as they pose a hazard in school and sporting activities. Children also get upset if they go missing or are broken.



It is an Education Department requirement that all students wear hats when in the sun. Therefore school hats are to be worn all year round at school, whenever the students are outside. If a child forgets their hat they will be required to sit in the shade of the verandah during recess and lunch breaks.

The following items can be purchased from the Uniform Shop.

BLUE POLO SHIRT	WARM UP JACKET
NETBALL SKIRT/SKORT	WARM UP PANTS
BOYS SHORT	BUCKET AND LEGIONNAIRE HATS

Black pants/bike pants/skorts can be purchased from local department stores, but they must be plain – no black denim or logos.

Plain blue, red or green Faction Shirts can again be purchased from local stores.

Shoes can either be joggers or buckled up sandals.

Orders can be lodged through the P&C Facebook page or through the office. Paid uniform orders can be left with the school office. Our Uniform Shop Coordinator will fill the orders weekly, and deliver the items to the child's classroom.

Please remember to NAME ALL ITEMS OF CLOTHING, especially jackets and hats.

School Factions

The school has three Factions – Blue, Green and Red. During Term 3 students can wear their faction shirts to school on Fridays as we train for our annual Sports Carnival.

Faction shirts need to be plain coloured with no logos etc., and can be purchased from stores such as Big W, K Mart, Best n Less etc. Blue faction students CANNOT wear their school shirt,

Mobile Phones

Mobile phones and other electronic devices brought to school by students need to be handed in to the front office at the start of each day. Valuables should not be brought to school. The school does not have a legal right or the human resource capacity to investigate theft, so any student that leaves a mobile phone or any other device in their bag is unlikely to be able to retrieve it in the event of theft.

Homework

At Yangebup we believe homework to be worthwhile as it extends learning opportunities beyond the school environment.

Homework is a positive learning tool that develops, consolidates and reinforces skills and understandings presented in class.

We recognise and strongly agree that homework assists in developing sound work routines, organisational skills and self-discipline and should be of educational value. Homework is the responsibility of the home.

The purpose of homework is

1. For students to practise and reinforce what has been learned in class.
2. For students to develop sound study and work habits.

Homework will not be set for children who are sick or who are going away on holiday. For these children we suggest (a) reading (b) journal writing (c) practical mathematics eg. Kilometres travelled.

Parent Involvement

- To provide an area where the child feels comfortable.
- To monitor the time spent on homework- a routine time block taking into account other activities.
- To check and sign homework tasks.
- To show interest and to offer guidance but not to solve content problems.
- To notify the teacher in writing, via the communication book, if the homework could not be completed by the due date.

Communication and Reporting

Throughout the year a variety of methods will be used to communicate between students, parents and staff. These include:-

Parent Teacher Interviews	As requested
Newsletter	Fortnightly (Thursdays)
Connect	
Facebook	Regular updates/reminders
Skoolbag	Smart phone FREE app
Communication Diary	Weekly
Academic Reports	End of Terms 2 & 4

School Nurse

The School Nurse provides screening of vision, hearing and development for all Kindy students, and/or any child commencing school for the first time in Pre Primary and Year 1, on completion of a consent form (including children that are new to the country). The School Nurse is also available for children that parents and/or teachers have concerns with. The School Nurse will send out consent forms early in the year.

2021 Term Dates

Semester One

Term 1 Monday 1st February – Thursday 1st April

Term 2 Tuesday 20th April – Friday 2nd July

Semester Two

Term 3 Monday 19th July – Friday 24th September

Term 4 Monday 11th October – Thursday 16th December

2021 Pupil Free Days

Term 1 Thursday 28th Jan and Friday 29th Jan

Term 2 Monday 19th April

Term 3 Monday 19th July

Term 4 Friday 5th November

2021 Public Holidays

Monday 1st March – Labour Day

Monday 26th April – Anzac Day

Monday 7th June – WA Day

Breakfast Club

Due to COVID this service was suspended in 2020. Hopefully it will resume in 2021.

School Dentist

Our School Dentist is located at South Lake Primary School on Mason Court, South Lake.

Their contact number is 9417 3242

Before and After School Care

Teddy Bear Corner OSHC Club operate a Before and After School program on our school grounds. Vacation Care is also offered.

Contact: 9337 3538 or visit www.teddybearcorner.com.au

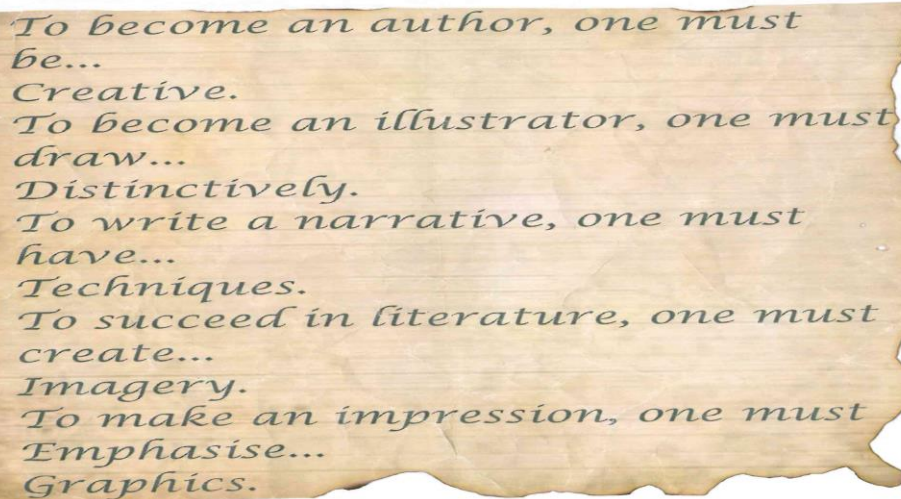

*To become an author, one must
be...
Creative.
To become an illustrator, one must
draw...
Distinctively.
To write a narrative, one must
have...
Techniques.
To succeed in literature, one must
create...
Imagery.
To make an impression, one must
Emphasise...
Graphics.*

Communicable Diseases

It is possible that at some time during your child's education he/she will contract one of the common diseases of childhood. Parents are asked to note the exclusion periods for particular diseases, as the danger of spreading the infection is prominent not only whilst the child is suffering from early symptoms, but they can still retain infection in their person or clothing after symptoms fade. For some diseases exclusion period details are provided by the Health Department.

Chicken Pox – Exclude from school. Where no medical certificate of recovery is available, exclude until all vesicles have crusted. Contacts need not be excluded.

Ringworm – Exclude from school until person has received antibiotics for 24 hours, contact need not be excluded. Ointment is available from all chemists.

Rubella (German Measles) – Exclude from school until at least 4 days after onset of rash. Contacts need not be excluded.

Measles – Exclude from school. Where no medical certificate of recovery is available, re-admit four (4) days from the appearance of spots, if well. Unimmunised contacts should be excluded until 14 days after the onset of the rash in the last case occurring at the school. If unimmunised contacts are vaccinated with MMR within 72 hours of their first contact with the first case, or Immunoglobulin within 6 days of exposure they may return to school following vaccination.

Whooping Cough – Exclude from school until 5 days after appropriate antibiotic treatment or for 21 days from onset of coughing.

Head Lice (Pediculosis) – The health Department recommends that long hair should be tied back to help combat head lice. Children should be **excluded from school** until effective treatment has been given and all lice removed from the hair. Contacts are not excluded, but should also be treated as a precautionary measure, as should all sheets, pillows etc.

PARENTS MUST CHECK THEIR CHILDREN REGULARLY.

Hepatitis – Transmitted through contact with infected persons. Incubation period around thirty (30) days. **Exclude from school**; re-admit only with a medical certificate of recovery but not before 7 days after onset of illness. Contacts need not be excluded.

Conjunctivitis – Discharged inflamed eyes. Must be excluded from school until discharge is cleared.

2021 TERM CALENDAR

TERM ONE (Feb 1st-April 1)

WEEK	MON	TUE	WED	THUR	FRI
1	Feb 1	2	3	4	5
2	8	9	10	11	12
3	15	16	17	18	19
4	22	23	24	25	26
5	Mar 1 Labour Day	2	3	4	5
6	8	9	10	11	12
7	15	16	17	18	19
8	22	23	24	25	26
9	29	30	31	Apr 1	Good Friday

TERM TWO (April 19th-July 2nd)

WEEK	MON	TUE	WED	THU	FRI
1	Apr 19	20	21	22	23
2	26 Anzac Day	27	28	29	30
3	May 3	4	5	6	7
4	10	11	12	13	14
5	17	18	19	20	21
6	24	25	26	27	28
7	31	Jun 1	2	3	4
8	7 WA Day	8	9	10	11
9	14	15	16	17	18
10	21	22	23	24	25
11	28	29	30	Jul 1	2

TERM THREE (July 19th-Sept 24th)

WEEK	MON	TUE	WED	THU	FRI
1	Jul 19	20	21	22	23
2	26	27	28	29	30
3	Aug 2	3	4	5	6
4	9	10	11	12	13
5	16	17	18	19	20
6	23	24	25	26	27
7	30	31	Sep 1	2	3
8	6	7	8	9	10
9	13	14	15	16	17
10	20	21	22	23	24

TERM FOUR (Oct 11th-Dec 16th)

WEEK	MON	TUE	WED	THU	FRI
1	Oct 11	12	13	14	15
2	18	19	20	21	22
3	25	26	27	28	29
4	Nov 1	2	3	4	5
5	8	9	10	11	12
6	15	16	17	18	19
7	22	23	24	25	26
8	29	30	Dec 1	2	3
9	6	7	8	9	10
10	13	14	15	16	

Interm Swimming Lessons

School Development Days

Public Holidays

Notes

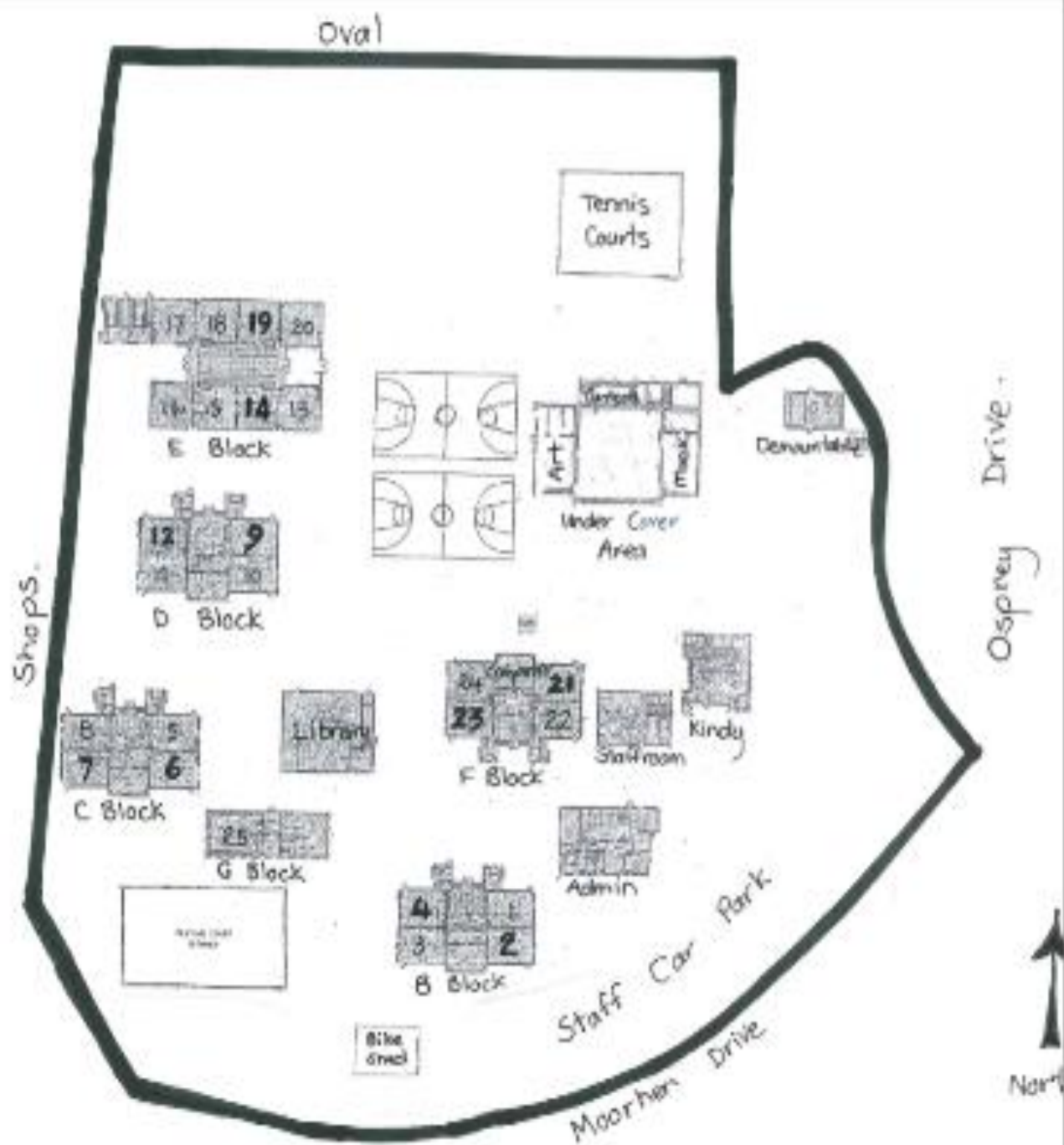

YANGEBUP PRIMARY SCHOOL

55 Moorhen Drive
Yangebup WA 6164

Tel: 9395 3200

Email: yangebup.ps@education.wa.edu.au

Direct Debit Banking Details

BSB 016 016
Account 492 139 294

Office Hours 8.00am-4.00pm